

Dallas Area Rapid Transit (DART) Silver Line Project

Addison Art & Design Update

October 26, 2021

The logo for the Addison station, featuring the word "ADDISON" in a bold, blue, sans-serif font centered within a white circle. This circle is set against a blue background that is part of a larger graphic element on the right side of the slide, which includes a white circle and a grey triangle.

Silver Line & Art and Design Program

- Art and design of 10 Stations along the 26-mile Silver Line Corridor
- A team of architects, artists, engineers and neighborhood advisory committee members for each station collaborating from station concept to completion
- Architectural elements including paving and column cladding, site elements, landscaping and site-specific artwork
- Budget: \$140,000

Art and Design Committee

- Addison Council appointed the following members to the DART Cotton Belt Art and Design Committee on April 25, 2019:

- Patricia Adkins
- Judy Barrett
- Jon Birney
- Kim Boyle
- Barbara Daseke
- Margie Gunther
- Jay Ihrig
- Yasue Kulhanek
- Harriet Mellow
- Robin Moss
- Barbara Papas
- Derek Underwood
- Allen Weatherford
- Ron Whitehead

- Committee worked with artist Eric McGeheraty

Selected theme: “Sophisticated Fun.”

- Use of traditional and easy to maintain materials such as stone, bronze and brick pavers.
- Windscreens engraved with artist depictions of sculptures around Addison.
- Enhanced fencing along ramps at the entrance to the station resemble fireworks.
- Fiber-optic lights imbedded in bricks at the entrances.

Addison Station

ADDISON



Addison Station

ADDISON



Addison Station

ADDISON





Aerial Ballet Monarch



Aigue-Marine

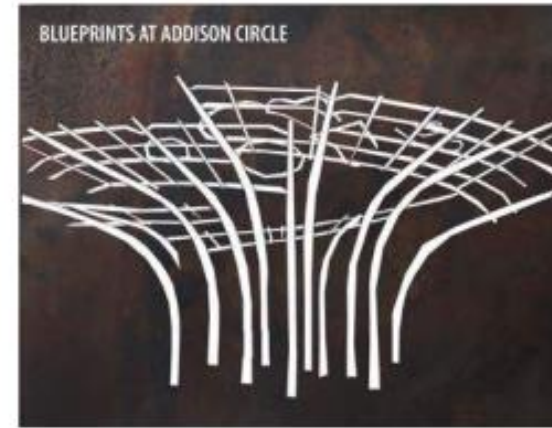

Blueprints

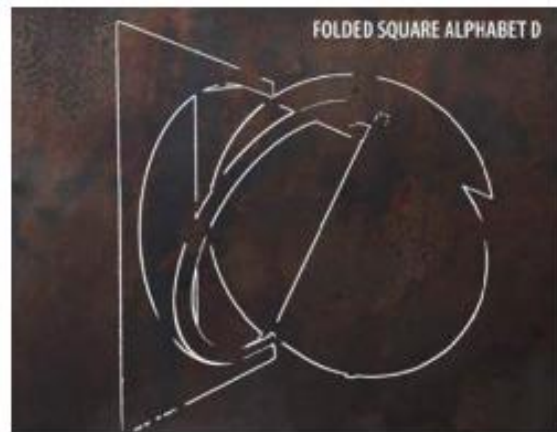

Folded D



Intersection in Flight



Jacks of All Trades



Let's Play

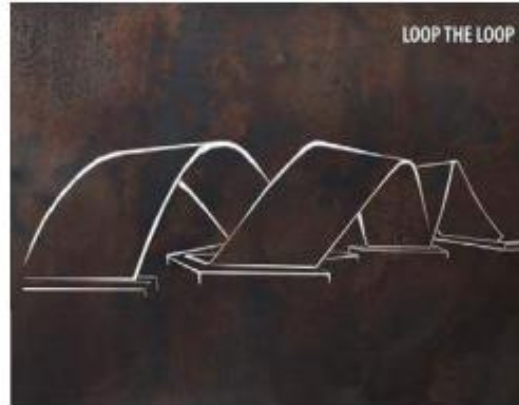

Loop the Loop



Lost in Wisconsin



Peace & Tranquility



Spectra



Tango Fantasia

Addison Station



Addison Station_ MATERIALS

PAINT

PT-01

SW 3072 DRIFTWOOD – SHERWING WILLIAMS

PT-14

SW 6153 PROTÉGÉ BRONZE – SHERWING WILLIAMS

PAVING

ADDISON CITY BRICK



FLAGSTONE - ASHLAR



DIAMOND SAW-CUT
NATURAL CONCRETE



COLUMN CLADDING ST-02

SPLIT SURFACE LIMESTONE
ASHLAR PATTERN



BLUE POLYCARBONATE



PT-14



FROSTED POLYCARBONATE



Addison Station

ADDISON



Construction Challenges

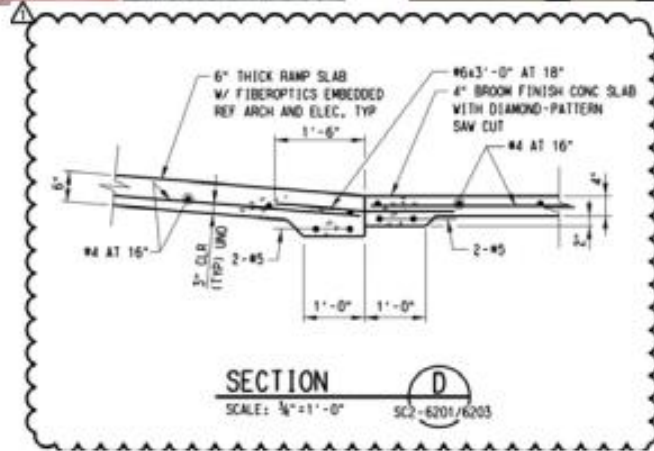
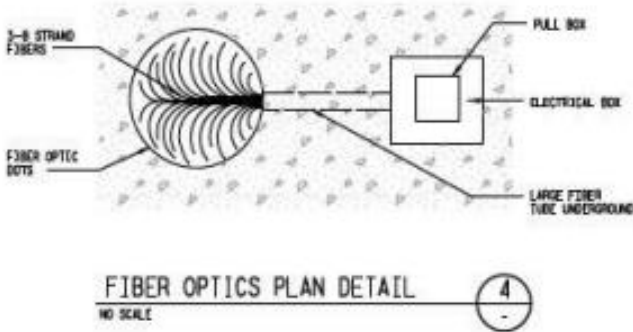
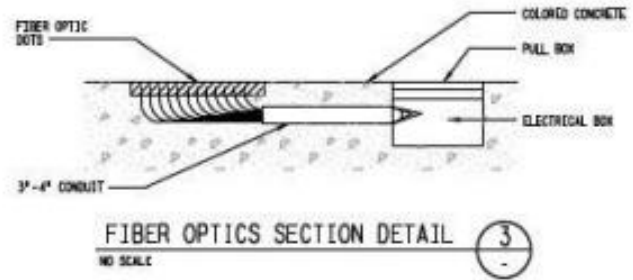

let's go.

Art & Design Proposed Changes

- Proposal to remove fiber optic lighting from design and include items requested by the Art & Design Committee:
 - Interior illumination of column cladding for Capital A
 - Interior illumination of column cladding for blue strip
 - Total of 24 columns
- Station entry sloped walkway finish to be updated to:
 - Include diamond cut patters to match Addison Circle
 - Match concrete finish to center of platform



Art & Design Proposed Changes

ADDISON



Art & Design Proposed Changes

ADDISON



Art & Design Proposed Changes

ADDISON



Design Build Schedule



CONSTRUCTION 90-DAY SCHEDULE



TOWN OF ADDISON Type of Work		Expected Duration of Work													
		SEPTEMBER					OCTOBER				NOVEMBER				
		1-4	5-11	12-18	19-25	26-30	1-9	10-16	17-23	24-31	1-6	7-13	14-20	21-30	
Civil	Maintain Stormwater Prevention Protection Plan (SWPPP) Installation Site and Land Clearing														
Rail	Guideway Construction														
Stations	Addison Station														
Structures	Midway Bridge Construction ***Retaining Wall Demo Drainage (Midway to Addison Rd.)														
Systems/Electrical	Addison Station Electrical														
Traffic	No Activity														
Utilities	Explorer Pipeline Midway Rd. Future MCI Relocation (Marsh - Quorum)														

* Permits have not been submitted. These are projected dates for closures. Proper construction notifications will be sent out.

- * Contingent on approved permits/easement
- ** Contingent on Rail Road Agreement
- *** Pending Utility Relocation



Due to the COVID-19 pandemic, all public involvement sessions will take place via video conference. DART urges you to follow the guidelines from the Centers for Disease Control and Prevention (CDC) to keep your family healthy and safe. Stay up to date by attending public involvement sessions online, signing up for construction alerts, visiting DART.org/SilverLine or calling 214-749-2835.

For all questions, comments and concerns, please email the DART Silver Line Project Team at SilverLine@DART.org

Questions?